

INTERNATIONAL  
STANDARD

**ISO**  
**2726**

Second edition  
1995-12-01

---

---

**Woodworking tools — Metal-bodied bench  
planes, plane cutters and cap irons**

*Outils pour le travail du bois — Rabots métalliques, fers de rabots et  
contrefers*



Reference number  
ISO 2726:1995(E)

## **Foreword**

ISO (the International Organization for Standardization) is a worldwide federation of national standards bodies (ISO member bodies). The work of preparing International Standards is normally carried out through ISO technical committees. Each member body interested in a subject for which a technical committee has been established has the right to be represented on that committee. International organizations, governmental and non-governmental, in liaison with ISO, also take part in the work. ISO collaborates closely with the International Electrotechnical Commission (IEC) on all matters of electrotechnical standardization.

Draft International Standards adopted by the technical committees are circulated to the member bodies for voting. Publication as an International Standard requires approval by at least 75 % of the member bodies casting a vote.

International Standard ISO 2726 was prepared by Technical Committee ISO/TC 29, *Small tools*.

This second edition cancels and replaces the first edition (ISO 2726:1973) as well as ISO 2728:1982, which have been technically revised.

© ISO 1995

All rights reserved. Unless otherwise specified, no part of this publication may be reproduced or utilized in any form or by any means, electronic or mechanical, including photocopying and microfilm, without permission in writing from the publisher.

International Organization for Standardization  
Case Postale 56 • CH-1211 Genève 20 • Switzerland

Printed in Switzerland

# Woodworking tools — Metal-bodied bench planes, plane cutters and cap irons

## 1 Scope

This International Standard specifies the characteristics of metal-bodied bench planes, plane cutters and cap irons.

## 2 Metal-bodied bench planes

### 2.1 Nomenclature

See figure 1.

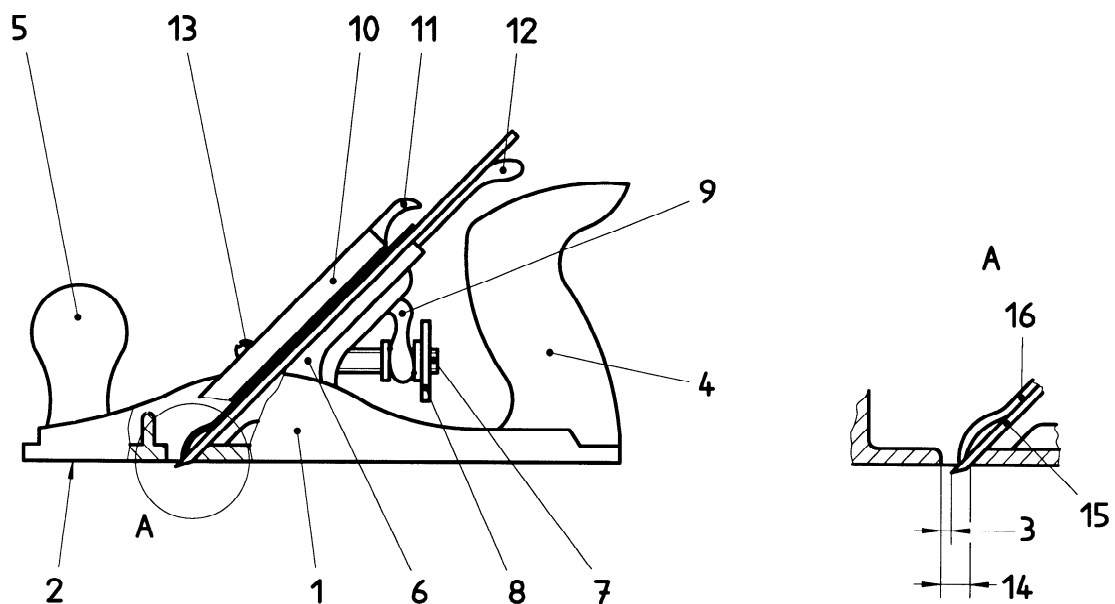

#### Key

1	Plane body	7	Adjusting screw	13	Lever cap screw
2	Sole	8	Adjusting nut	14	Mouth
3	Clearance	9	Depth adjusting lever	15	Plane cutter
4	Handle	10	Lever cap assembly	16	Cap iron
5	Knob	11	Lever cap lock		
6	Frog	12	Lateral adjusting lever		

Figure 1 — Nomenclature